

# [303A<sub>v2</sub>] Gerflor Smart Fix 16 dB

CONDITIONS

SUBSTRATES

ACCESSORIES

INSTALLATION

## LAYING CONDITIONS

AUTHORIZED FLOOR COVERINGS		Virtuo 30 and 55, Creation 30 Design, Création 40 Trend, Creation 55 Trend (see installation guidelines of the floor covering).
SUBSTRATE EVENNESS	Flatness requirement: < 5 mm / 2 metre ruler and < 1 mm / 20 cm ruler	Flat, clean, sound, dry and solid substrate.
STORAGE	At least 24 hours prior to installation	Store the underlayer in the room where it is going to be laid.
LAYING TEMPERATURE	15-26°C	Ideally 20°C.
PERIMETER EXPANSION GAP	5 mm	Around the edges of the room, fixed objects and door frames. The gap must be covered by a finishing profile.
DIVISIONS	Every 10 linear metres or surface area > 150 m	Each closed room or premises must be considered separately. Divide by applying Gerflor Fix&Free 100 double-sided adhesive tape to fix the underlayer to subfloor.
DIRECT SUNLIGHT (SUNNY AREAS, BAY WINDOWS, SKYLIGHTS, SKYDOMES, ETC.)	Floor temperature < 60°C	Loose laying is allowed as long as the ambient temperature is regulated. In order to prevent the floor temperature from reaching excessive values up to 60°C or above, direct sunlight on the floor should be obscured by curtains, blinds or other suitable protection. Otherwise, maintain the underlayer and the tiles/planks in place with a suitable adhesive (please contact the adhesive manufacturer).
VERANDA/CONSERVATORY	Prohibited	Prohibited, irrespective of the substrate.
FIRST USE	Pedestrian traffic - 48h Installation of the furniture - 72h	In case of underfloor heating, wait 7 days before turning the heating back on.

\*The underlayer is intended for use under the floor during installation in residential areas. It is not suitable for use under a herringbone pattern floor.

## USAGE CONDITIONS

USAGE TEMPERATURE	Acceptable temperature range after installation : 20°C	e.g. +10°C to 30°C
STATIC LOADS	< 30 kg/cm <sup>2</sup> and < 200 kg/support	Do not use rubber end caps. Use flat (not tapered) end caps without any pattern that are suitable for PVC. Use end caps on furniture legs.
CASTOR CHAIRS	PVC-compatible castors according to EN 12529	Recommendation: protective mat beneath castor chairs.

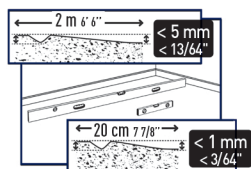

SUBSTRATE EVENNESS

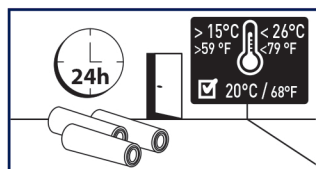

STORAGE

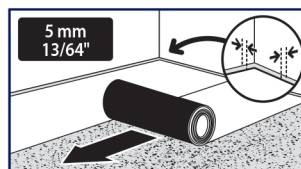

PERIMETER EXPANSION GAP

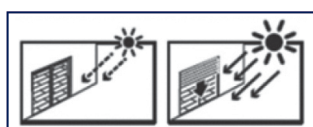
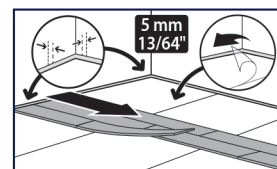

DIRECT SUNLIGHT



STATIC LOADS

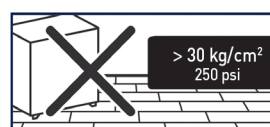

IMPORTANT : The information in this document is valid from: 26/09/2022 and is subject to change without notice. As we carry out continuous technical improvements, our customers should check with us that this document is still in force before starting any work.

**Gerflor**