



Made by Kronospan

HERRINGBONE 8

630 x 126 x 8 mm



20 years guarantee	abrasion class ★★★★★ AC5	real groove 4
authentic embossed	anti bacterial comfort + A.B.C.	eco-friendly naturally wood
fold down		



everyone's favourite flooring

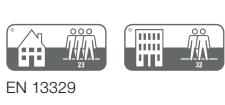

EN 13329

20 year residential warranty* · Four sided V-groove · Authentic embossed structure gives a natural look and feel · A.B.C. Antibacterial surface** · Eco-friendly · For domestic use with heavy utilisation · For commercial use with general utilisation

20 Jahre Garantie im Wohnbereich* · Umlaufende V-Fuge · Authentic Embossed Struktur verleiht natürliche Optik und Haptik · A.B.C. Antibakterielle Oberfläche** · Umweltfreundlich · Für Wohnbereiche mit intensiver Nutzung · Für gewerbliche Bereiche mit mittlerer Nutzung

20 ans de garantie pour usage domestique* · Chanfrein en V sur les 4 côtés · La structure gaufrée authentique confère un aspect et un toucher naturels · A.B.C. surface anti-bactérienne** · Écologique · Usage domestique soutenu · Usage commercial général

garantía residencial de 20 años* · bisel en V en cuatro lados · la estructura sincronizada aporta un aspecto y tacto natural · A.B.C. superficie antibacteriana** · eco amigable · uso doméstico intensivo · para zonas comerciales de uso general

20 de ani garanție pentru trafic casnic intens* · Rost în V pe toate laturile · Suprafață mată, cu por lucios, sincronizată, pentru aspect și tactilitate naturală · A.B.C. suprafață antibacteriană** · Prietenos cu mediul · Pentru spații rezidențiale cu trafic intens · Pentru spații comerciale cu trafic mediu



www.blauer-engel.de/uz176

* The guarantee is valid for domestic use according to the conditions of guarantee. · Die Garantie gilt für den Wohnbereich gemäß Garantiebestimmungen. · La garantie est valable pour l'habitation conformément aux conditions de garantie. · La garantía es válida para uso doméstico de acuerdo a las condiciones de la garantía. · Garanția este valabilă pentru spații rezidențiale conform condițiilor de garanție. Detailed terms of guarantee · Ausführliche Garantiebedingungen · Conditions de garantie détaillées · Condiciones de garantía detalladas · Condiții detaliate de garanție: www.krono-original.com

** Tested germs · Getestete Bakterien · Germs testés · Bacterias analizadas · Bacterii testate: Staphylococcus aureus

Производител: ООО Кроноспан, Германия, Вносител: Кроноспан България ЕООД, с. Равно Поле, Индустриална зона Верила, Тел. 02/4001783 · Importer na Polskę: Kronospan KO Sp. z o.o. ul. 1 Maja 52, 47-100 Strzelce Opolskie, Polska · Magyar importőr: Falco Zrt, H-9700 Szombathely, Zanati út 26 · Importator pentru România: Kronospan Trading SRL, Sebes, Str. Mihail Kogalniceanu, nr. 59, et.1, cam. 1/12 Tel: 0040 258 801 190, Fax: 0040 258 801 199 · Manufacturer: Kronoflooring GmbH, Germany, Importer: Kronospan Ltd., Holyhead Road, Chirk, Wrexham LL14 5NT, United Kingdom, tel: +44 1691 77 33 61, fax: +44 1691 77 32 92, info@kronospan.co.uk

C11-s1	E1 HCHO	2	EPLF MADE WITH WOOD	M1	PEFC PEFC/04-31-0546
floor score	eco INSTITUT TESTED PRODUCT ID 1117 - 33374 - 001	CARB2 CARB P2 & U.S. EPA TSCA Title VI compliant conforme au titre VI de la TSCA			

ÉMISSIONS DANS L'AIR INTÉRIEUR*

A+

A+ A B C

* Information sur le niveau d'émission de substances volatiles dans l'air intérieur, présentant un risque de toxicité par inhalation, sur une échelle de classe allant de A+ (très faibles émissions) à C (fortes émissions). Statement on level of emission of volatile substances in indoor air posing a toxic threat during inhaling – on a scale from A+ (very low-emission) to C (high-emission). Angabe über den Grad der Emission von flüchtigen Substanzen in der Raumluft, die ein toxisches Risiko beim Einatmen darstellen, auf einer Skala A+ (sehr emissionsarm) bis C (hohe Emissionen). www.eco-institut.de/e/portfolio/emissions-dans-lair-interieur

TÜV PROFI
QUALITY TESTED
tested for: emissions harmful substances EPH
PREMIUM

WARNING: Drilling, sawing, sanding or machining wood products can expose you to wood dust, a substance known to the State of California to cause cancer. Avoid inhaling wood dust or use a dust mask or other safeguards for personal protection. For more information go to www.P65Warnings.ca.gov/wood. ATTENTION : Percer, scier, poncer ou usiner des produits en bois peuvent vous exposer à la poussière de bois, une substance connue dans l'État de Californie pour causer le cancer. Évitez d'inhaler la poussière de bois ou utilisez un masque à poussière ou d'autres moyens de protection. Pour plus d'informations, consultez le site: www.P65Warnings.ca.gov/wood

Storage · Lagerung · Entreposage
Almacenamiento · Depozitarea

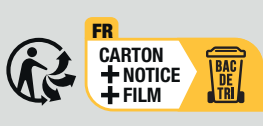

deu Vor dem Verlegen bitte auch die Online Verlegeanleitung beachten unter: www.floor-installation.com **HINWEIS!** Bitte Paneele vor dem Verlegen kontrollieren. Bei evtl. Oberflächenfehlern (müssen erkennbar sein aus einer Abstandshöhe von 1,5 m) die betroffenen Paneele aussortieren! **eng** Before installing the floor, please also refer to the online installation instructions: www.floor-installation.com **NOTE!** Please check all panels for defects before installation. Any panels with visual defects (visible from a height of 1.5 m / 5 ft) should not be installed. **fra** Avant la pose, consulter les instructions de pose online sur : www.floor-installation.com **INDICATIONS!** Vérifiez les lames avant la pose. Une lame présentant un défaut visible (d'une hauteur de 1,5 m) ne doit pas être installée. **spa** Antes de colocar el producto, tenga en cuenta las instrucciones de colocación online disponibles en: www.floor-installation.com **NOTA!** Inspeccione los paneles antes de colocarlos. En caso de que existan fallos en la superficie (deberán poder reconocerse desde una altura de 1,5 m), excluir los paneles afectados. **ron** Înainte de a instala podeaua, consultați și instrucțiunile de instalare online: www.floor-installation.com **NOTĂ!** Verificați defectele tuturor placilor înainte de instalare. Nu trebuie instalate placile cu defecte vizuale (vizibile de la o înălțime de 1,5 m).

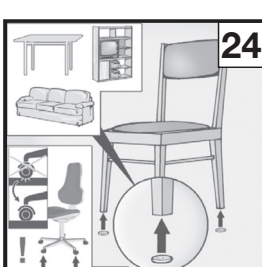
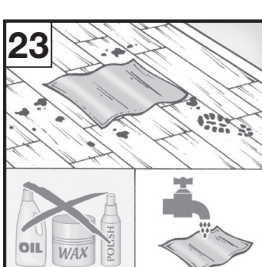
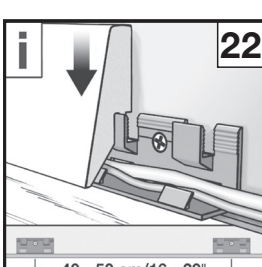
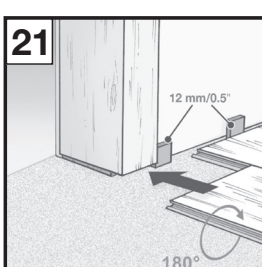
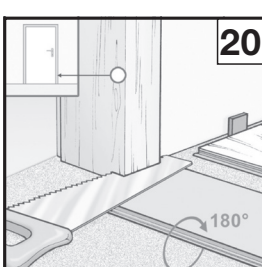
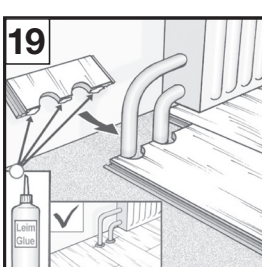
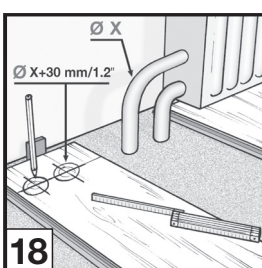
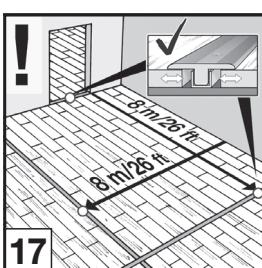
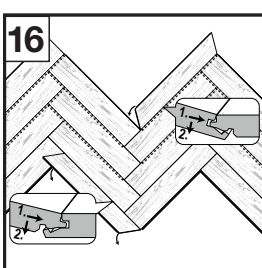
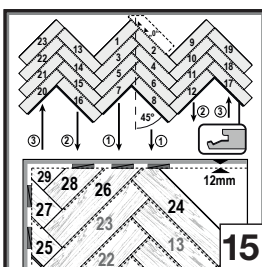
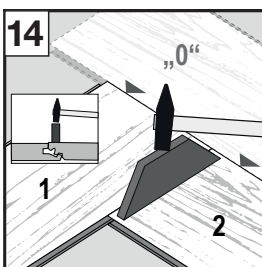
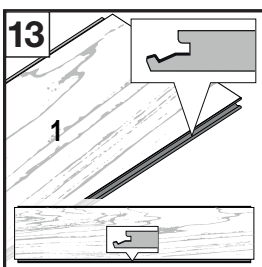
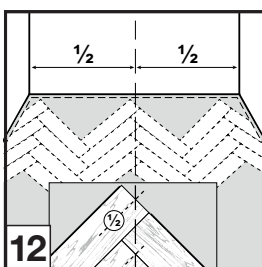
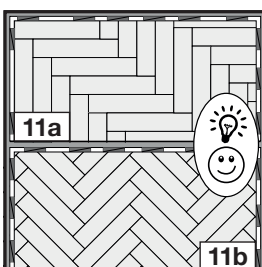
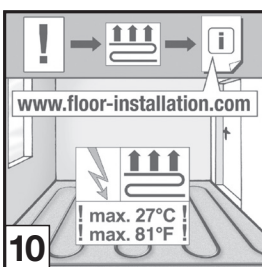
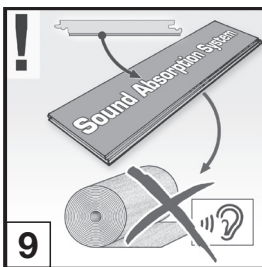
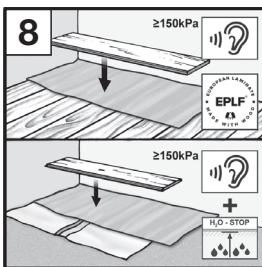
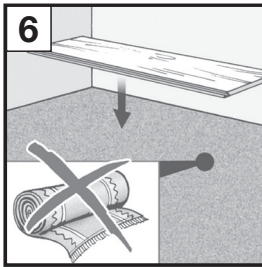
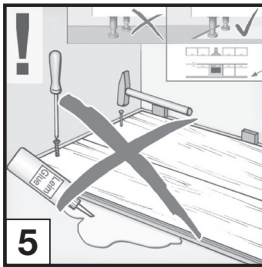
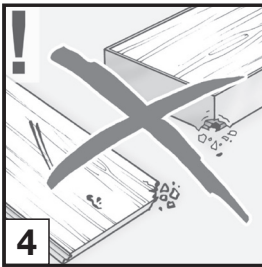
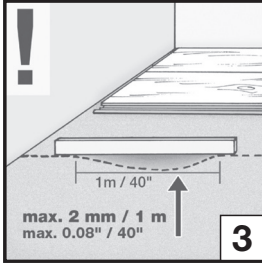
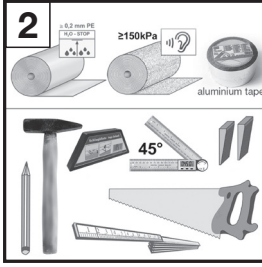
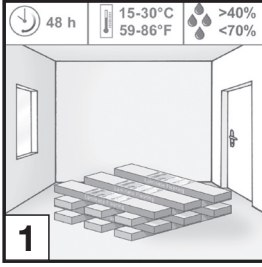

Die Entsorgung hat über den Restmüll zu erfolgen. Disposal has to be made via residual waste. Le produit doit être mis au rebut avec les déchets non recyclables. La eliminación de este producto deberá realizarse a través de desecho inorgánico. Eliminarea trebuie făcută prin deșeuri reziduale.